

TOČKA	X	Y	Z
T91	106.481,07	402.913,80	760,49
T92	106.486,66	402.911,61	760,55
T93	106.489,04	402.909,32	759,75
T94	106.490,27	402.908,89	759,43
T95	106.491,56	402.909,00	759,11
T96	106.497,04	402.912,11	758,49
T97	106.502,36	402.914,89	757,90
T98	106.507,72	402.917,58	757,31
T99	106.513,18	402.920,08	756,77
T100	106.518,72	402.922,38	756,22
T101	106.524,33	402.924,49	755,67
T102	106.530,02	402.926,40	755,20
T103	106.541,52	402.929,83	754,26
T104	106.547,30	402.931,44	753,79
T105	106.570,76	402.937,77	750,71
T106	106.577,06	402.937,78	749,91
T107	106.583,06	402.937,58	749,34
T108	106.595,04	402.937,02	748,21
T109	106.607,72	402.936,09	747,15
T110	106.627,92	402.934,34	745,52
T111	106.645,49	402.936,45	744,19
T112	106.674,22	402.935,73	741,06
T113	106.682,60	402.929,26	740,35
T114	106.685,32	402.928,32	740,22
T115	106.697,62	402.928,55	739,40





T116	106.703,75	402.927,09	738,97
T117	106.709,54	402.925,50	738,55
T118	106.715,26	402.923,70	738,14
T119	106.720,92	402.921,71	737,73
T120	106.726,49	402.919,47	738,09
T121	106.731,95	402.916,99	738,44
T122	106.737,32	402.914,32	738,28
T123	106.742,60	402.911,47	736,29
T124	106.758,13	402.902,36	734,83
T125	106.773,49	402.892,98	734,38
T126	106.778,72	402.890,04	734,23
T127	106.784,04	402.887,27	734,08
T128	106.789,46	402.884,70	733,96
T129	106.795,25	402.882,20	733,89
T130	106.796,29	402.881,74	733,91
T131	106.814,72	402.883,92	734,44
T132	106.820,63	402.884,97	734,84
T133	106.838,29	402.888,44	735,86
T134	106.844,49	402.889,54	736,56
T135	106.854,06	402.888,72	737,30
T136	106.866,45	402.890,98	737,93
T137	106.867,66	402.891,46	738,00
T138	106.872,95	402.894,88	738,04
T139	106.877,48	402.899,26	738,07

T140	106.878,57	402.899,97	738,28
T141	106.879,78	402.900,45	738,68
T142	106.881,06	402.900,68	739,07
T143	106.887,36	402.900,80	739,33
T144	106.893,63	402.900,70	739,41
T145	106.899,65	402.900,39	739,52
T146	106.905,68	402.898,56	739,75
T147	106.911,35	402.896,61	740,02
T148	106.934,05	402.887,94	741,42
T149	106.940,26	402.886,88	741,67
T150	106.958,86	402.887,16	743,39
T151	106.964,92	402.888,88	743,69
T152	106.975,67	402.894,86	744,23
T153	106.987,89	402.896,27	745,84
T154	106.993,82	402.897,17	746,71
T155	106.999,75	402.899,31	747,52
T156	107.005,98	402.900,25	748,50
T157	107.028,25	402.899,22	750,99

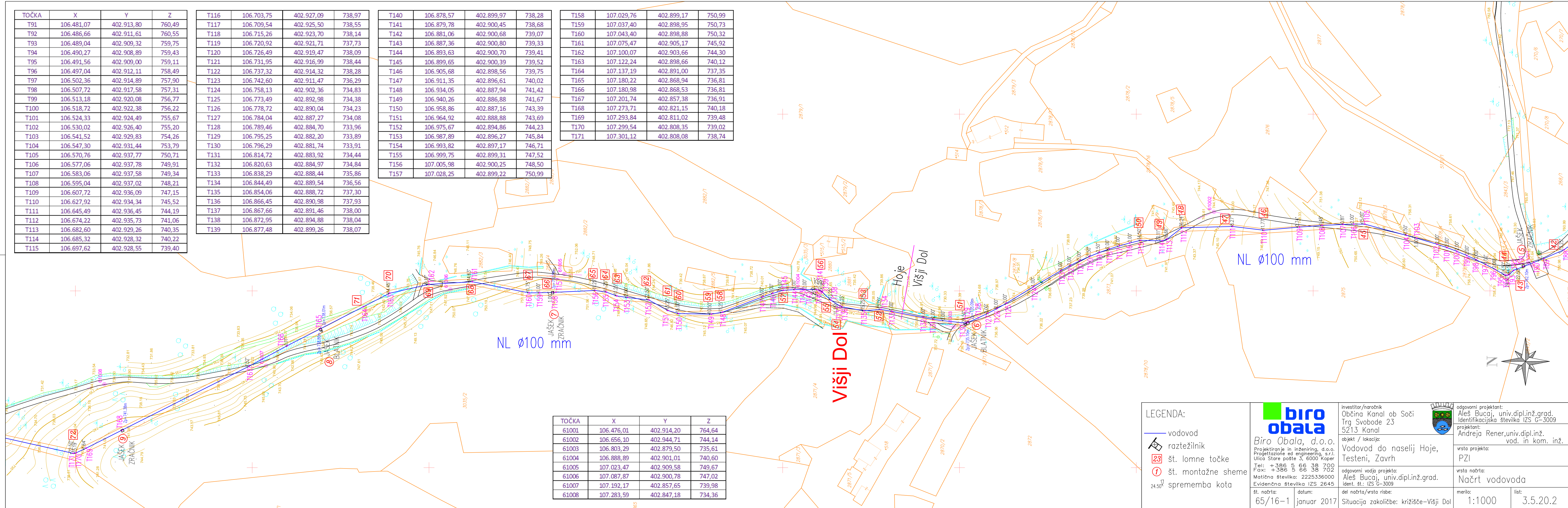
T158	107.029,76	402.899,17	750,99
T159	107.037,40	402.898,95	750,73
T160	107.043,40	402.898,88	750,32
T161	107.075,47	402.905,17	745,92
T162	107.100,07	402.903,66	744,30
T163	107.122,24	402.898,66	740,12
T164	107.137,19	402.891,00	737,35
T165	107.180,22	402.868,94	736,81
T166	107.180,98	402.868,53	736,81
T167	107.201,74	402.857,38	736,91
T168	107.273,71	402.821,15	740,18
T169	107.293,84	402.811,02	739,48
T170	107.299,54	402.808,35	739,02
T171	107.301,12	402.808,08	738,74

TOČKA	X	Y	Z
61001	106.476,01	402.914,20	764,64
61002	106.656,10	402.944,71	744,14
61003	106.803,29	402.879,50	735,61
61004	106.888,88	402.901,01	740,60
61005	107.023,47	402.909,58	749,67
61006	107.087,87	402.900,78	747,02
61007	107.192,17	402.857,65	739,98
61008	107.283,59	402.847,18	734,36



LEGENDA:
 vodovod
 raztežilnik
 št. lomne točke
 št. montažne sheme
 24,50' sprememba kota

biro obala
 Biro Obala, d.o.o.
 Projektiranje in inženiring, d.o.o.
 Projektiranje ed engineering, s.r.l.
 Ulica Stare pošte 5, 6000 Koper
 Tel: +386 5 66 38 700
 Fax: +386 5 66 38 702
 Matična številka: 2225336000
 Evidenčna številka IZS 2645
 št. načrta: 65/16-1 datum: januar 2017

investitor/naročnik
 Občina Kanal ob Soči
 Trg Svobode 23
 5213 Kanal
 objekt / lokacija:
 Vodovod do naselij Hoje,
 Testeni, Zavrh
 odgovorni vodja projekta:
 Aleš Bučaj, univ.dipl.inž.grad.
 ident. št.: IZS G-3009
 del načrta/vrsta risbe:
 Situacija zakoličbe: križišče-Višji Dol

odgovorni projektant:
 Aleš Bučaj, univ.dipl.inž.grad.
 Identifikacijska številka IZS G-3009
 projektant:
 Andreja Rener, univ.dipl.inž.
 vod. in kom. inž.
 vrsta projekta:
 PZI
 vrsta načrta:
 Načrt vodovoda
 merilo: 1:1000 list: 3.5.20.2