

Prerez B-B

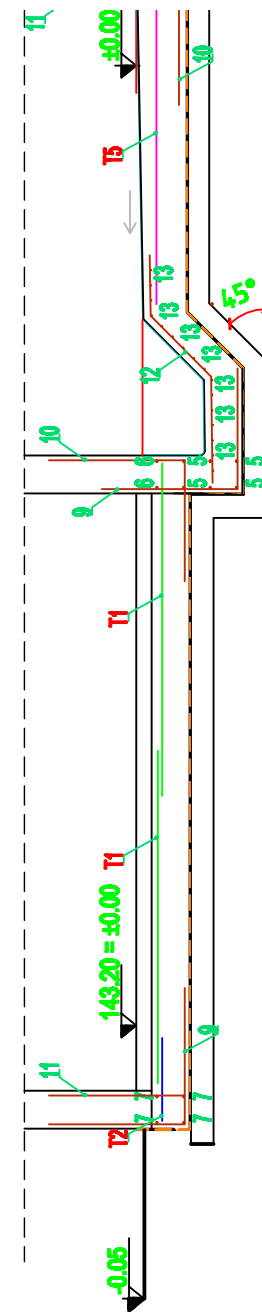

Prerez C-C

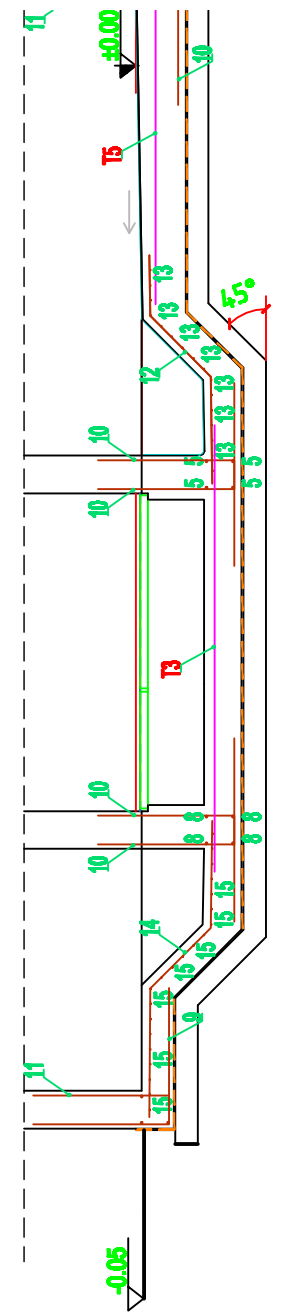

Seznam armature:

① Ø14 ; L = 4,40m ; kos 4

② Ø14 ; L = 2,11m ; kos 16

③ Ø14 ; L = 3,45m ; kos 4

④ Ø14 ; L = 2,52m ; kos 8

⑤ Ø14 ; L = 4,35m ; kos 8

⑥ Ø14 · T = 2 20m · kos 4

⑨ Ø12/12,5cm ; L = 1,80m ; kos 78

⑩ Ø10/20cm ; L = 1,80m ; kos 157

⑪ Ø10/20cm ; L = 1,99m ; kos 130

⑫ Ø8 ; L = 1,66m ; kos 39

⑬ Ø8 ; L = 4,30m ; kos 16

⑭ Ø8 ; L = 2,11m ; kos 28

⑮ Ø8 ; L = 3,20m ; kos 21

⑯ Ø10 ; L = 2,50m ; kos 8

⑰ Ø8/20cm ; L = 1,10m ; kos 50

⑱ Ø8/20cm ; L = 1,78m ; kos 25

⑲ Ø10 ; L = 1,50m ; kos 8

⑳ Ø10 ; L = 0,80m ; kos 8